



23<sup>rd</sup> September 2022

## ROAD CLOSURE BETWEEN WEST CENTRAL STREET AND GRAPE STREET: OCTOBER – NOVEMBER 2022

Dear Resident / Business,

As part of the West End Project, the works to create a new public space at Princes Circus is continuing with a road closure planned for October and November.

### Working on the road

We will be removing the old road surface on the section of road between West Central Street and Grape Street and replacing it with a new material. To maintain access for businesses and residents we will be working on the road in two sections so that access will always be available. On the other side of this letter is a map showing the areas that will be closed.

### Key information

- We will be working on the road between West Central Street and Grape Street
- Access will be maintained throughout the working dates
- Section A closed 3<sup>rd</sup> October – 19<sup>th</sup> October 2022
- Section B closed 20<sup>th</sup> October – 11<sup>th</sup> November 2022
- idverde working hours Mon - Fri: 8am – 5pm and as needed Saturday: 8am – 1pm
- 24 hour contact phone number: 0800 141 2543
- All work to the area is expected to be completed in Spring 2023

### Replacing the pavement

After we have completed the road works in November we will start work on replacing the pavement in front of the businesses in the areas marked in blue on the map to the right.

Access for pedestrians will be maintained at all times. We will visit each business before work starts to talk about the best time to work directly in front of each entrance so that businesses are impacted as little as possible.

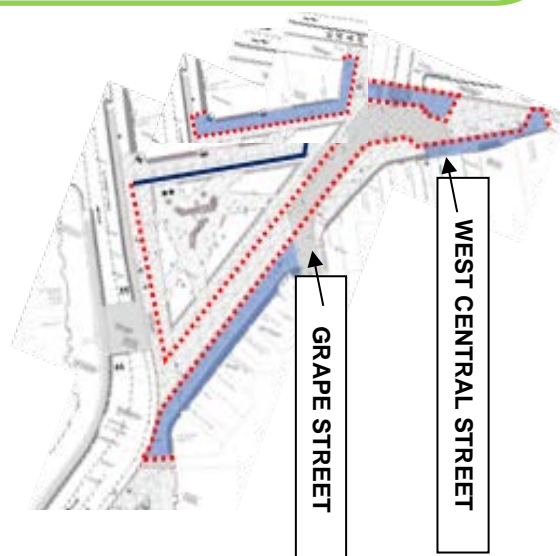

### Starting work on the south of the site

We will be starting work in the southern area of Princes Circus outside of the Shaftesbury Theatre from the last week in October.

For all works noise should be expected throughout the construction period and at any point during the permitted working hours. The loudest work is the demolition works and cutting of new paving slabs. Where possible acoustic barriers are being used to reduce the sound.

## Road closure map

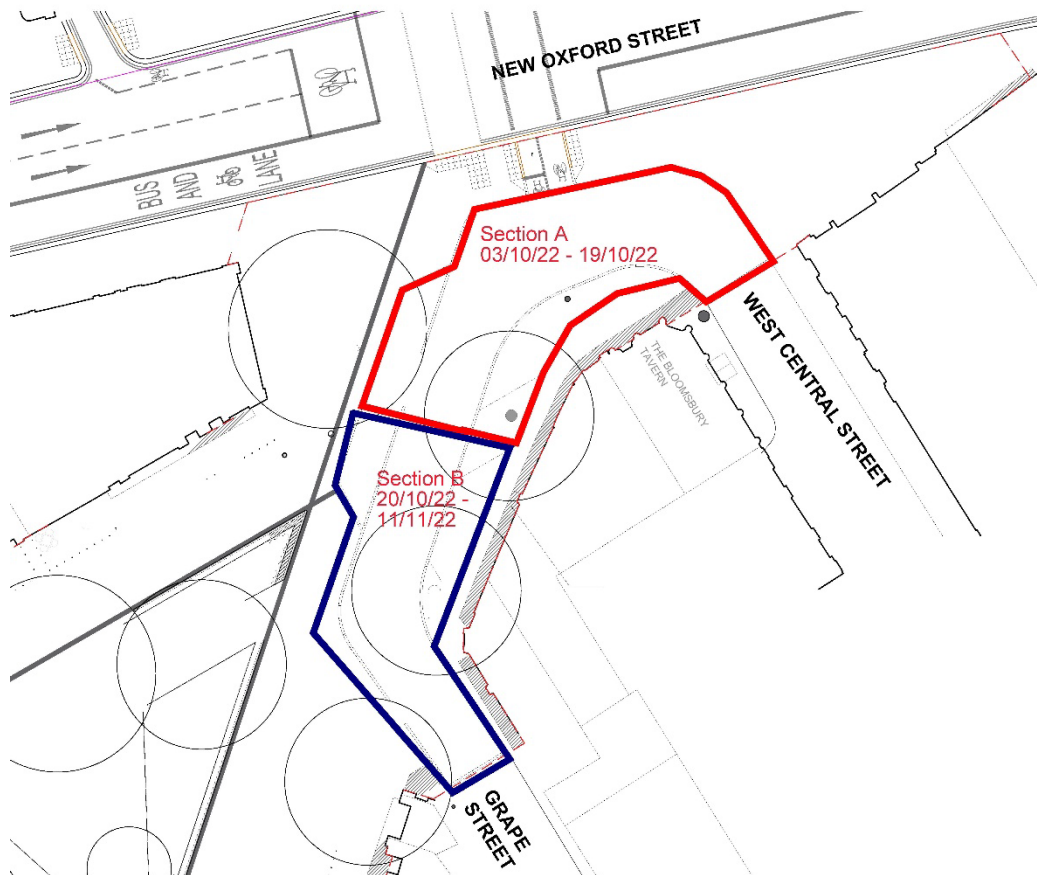

## Keep in touch

Please note that programme dates are subject to change and any delays will be updated on our website where we also continue to share the weekly look ahead of works. You can also sign up to our electronic newsletter for regular updates:

**[camden.gov.uk/westendproject](https://camden.gov.uk/westendproject)**

We apologise for any inconvenience that these works will cause. If you have any concerns during the construction period or would like to find out more on the project use our contact details to the right.

Website	<a href="https://www.camden.gov.uk/westendproject">www.camden.gov.uk/westendproject</a>
E-mail newsletter	Sign up via our website
24/7 contact	0800 141 2543
Email	<a href="mailto:westendproject@camden.gov.uk">westendproject@camden.gov.uk</a>

